

SENSITIVE EDGE TYPE “B1NC-AG”

The edge type B1NC-AG differs from type B1NC in the anchoring foot, which has been studied to make it interchangeable with most of profiles on the market, and for its completion accessories.

B1NC-AG
Universal foot

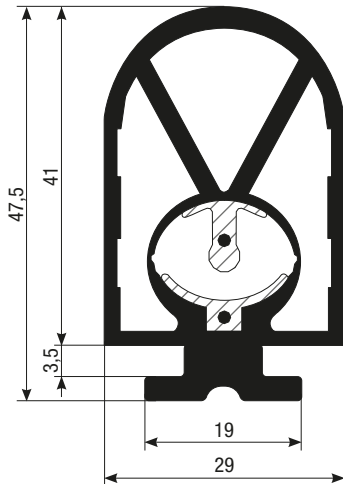

Roll of 25 m

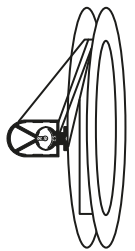

“DO-IT-YOURSELF” VERSION

Please order the single components according to the following pattern:

- 1 Pack of **profile type B1NC-AG** (standard roll of 25 m)
- 1 **Kit of end cap/needle connectors type KC1** (1 end cap/connector with electric cable type KC1AGC + 1 end cap / connector with resistance type KC1AGR)
- 1 **aluminium support**, unit of measure expressed in linear meters (type SAC25 – SAL25 – SAI25 for edge fastening)
- 1 **Primer** bottle (10ml) code PR
- 1 **Sealant** bottle (10ml) code CY

Kit of end caps/connectors type GSB1NCAGKC1AG containing:

KC1AGC | End cap/connector with cable | Length 3 m

KC1AGR | End cap/connector with resistance

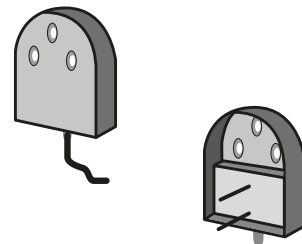

ALUMINIUM SUPPORT FOR EDGE FASTENING

The edge fastening is realised by installing the edge on a suitable aluminium support. Three types of supports are available.

Type “SAC25” | “C”-shaped profile | for edge type B1NC-AG

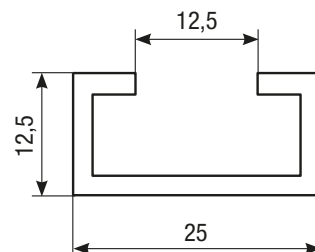

Type "SAL25" | "L"-shaped profile | for edges type B1NC-AG

Type "SAI25" | "I"-shaped profile for edges B1NC-AG

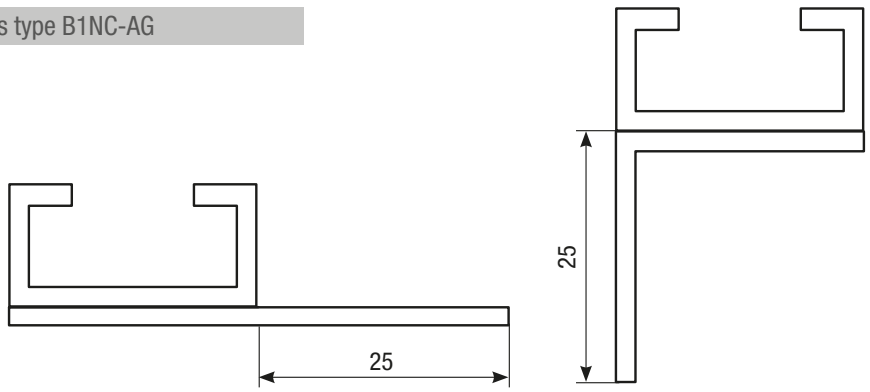

SUPPLY CABLE OUTLET

"UI" | Bottom part outlet

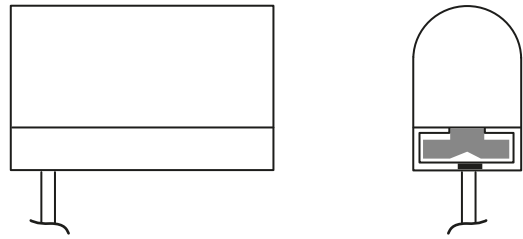

"CCCC" | Double outlet

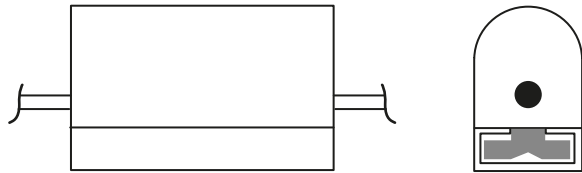

SEALANTS FOR "DO-IT-YOURSELF" EDGES

"GSBPR" | Primer bottle (10ml) type PR

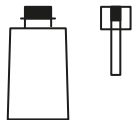

"GSBCY" | Sealant bottle (10ml) type CY



HOW TO ORDER AN EDGE TYPE "B1NC-AG" AND "B1NC-AGB" (ASSEMBLED)

Code

